

ISO-9001:2008 CERTIFICATED

PROFESSIONAL POWER TOOLS

For over 30 years, Tranmax has devoted itself to manufacturing and providing high quality products and service for professional applications. Our diverse and innovative product range has successfully fulfilled customers' needs and persistently meets market trends and demands. To learn more about Tranmax products, please visit www.tranmax.com

2022

PROFESSIONAL POWER TOOLS

Professional Manufacturer
since 1985



TP
TRANMAX
Tranmax Machinery

Tranmax Machinery Co., Ltd.

No. 130 Renhuagong 1st Road, Dali Dist,
Taichung City 412, Taiwan, R.O.C
Tel: +886-4-2495 2609
Fax: +886-4-2495 2647

Tranmax Machinery Co., Ltd.
www.tranmax.com

TP
TRANMAX
Tranmax Machinery

2022.12



Table of Contents

6	MECHONEER Series - Premium Series Impact Wrench	45	Air Finishing Tools
		46	Sanders
12	Air Impact Wrenches	53	Air Drills and Screwdrivers
13	Aluminum Impacts	54	Air Drills
20	Stubby Impacts	57	Air Screwdrivers
21	Composite Impacts		
23	Industrial Impact Tools - TDW series	59	Air Hammers and Needle Scalers
25	Oil-Bathed Type	61	Air Hammers
		62	Air Needle Scalers
26	Air Ratchet Wrenches	64	Special Tools
27	Aluminum Ratchets	65	Nut Setters & Tappers
30	Composite Ratchets	66	Caulking Guns
31	Sockets	66	Riveters
		66	Grease Guns
		67	Concrete Breakers
32	Air Grinders and Cutting Tools	68	Digital Torque Wrenches
33	Corner Grinder & Angle Grinders		
36	Die Grinders	70	Accessories
39	Composite Die Grinders - 1HP Series	70	Maintenance Parts
41	Composite Die Grinders		
44	Cutting Tools		



About Tranmax

Established in 1985, Tranmax Machinery Co., Ltd. has devoted itself to manufacturing and exporting high quality pneumatic tools for professional applications. Over 30 years of experience in developing Impact Wrenches, Ratchet Wrenches, Screwdrivers, Sanders, Grinders, Drills, etc., Tranmax has successfully earned popularity and a sound reputation in world-wide markets, especially in Germany, Netherlands, France, Italy, England and the United States. New innovations and improvements are persistently made to meet market trends and demands. Reliable products and customer satisfaction are what we always pursue. We welcome you to develop a mutually beneficial relationship with us on a long-term basis.



ISO 9001 Certificate



Air Tools and Pipe Fitting System

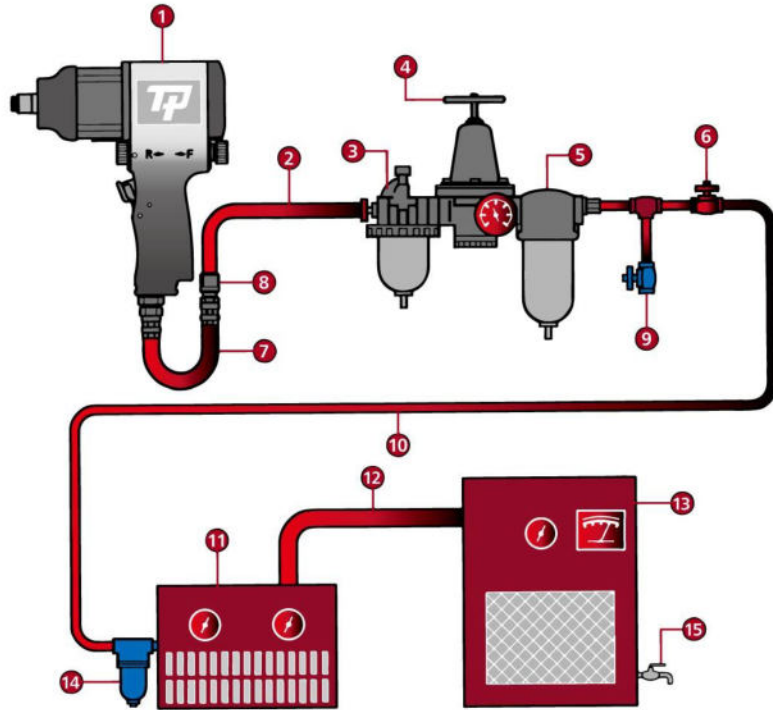

- | | | |
|-----------------------|-------------------------------------|-----------------------------------|
| 1. Air tool | 6. Shut off valve | 11. Air dryer |
| 2. Air hose 3/8" | 7. Lead hose | 12. 1" or larger pipe and fitting |
| 3. Oiler | 8. Coupler body and connector | 13. Air compressor |
| 4. Pressure regulator | 9. Drain daily | 14. Auto drain |
| 5. Filter | 10. 1/2" or larger pipe and fitting | 15. Drain daily |

CAUTION

1. A filter-regulator-lubricator is strongly recommended as it increases tool life and keeps the tool in sustained operation.
2. Water in the air line will cause damage to the tool. Drain the air tank daily.
3. Fill SAE 10 oil into the air inlet to lubricate before operating air tools.
4. Air pressure of 90 PSI measured at the tool while running free is recommended. Higher pressure and unclear air will shorten the tool's life because of faster wear and may create a hazardous condition.

Periodic Maintenance and Inspection

Items	Description	Inspection	Daily	Weekly	Remarks
1	Keep the air supply system clean and dry by checking the pipe and accessories and draining out the moisture in the pipe and separator.		•		All Air Tools
2	Always maintain the air pressure at 90 psi (6.3kg/ cm ²) to ensure tool performance. And double checking the pressure value during operation of the tool.		•		All Air Tools
3	Use the proper coupler, nipples, hoses, pipes, and fitting.		•	•	All Air Tools
4	Check if the quick coupler is in secure and correct connection.		•	•	All Air Tools
5	Keep the tools properly lubricated to prevent wear and rust.		•	•	All Air Tools
6	Clean and lubricate the tool when not using it, and store it in a clean and dry place.		•		All Air Tools
7	Always wear approved eye protection during operation of the tool. Do not wear loose or ill-fitting clothing to avoid injuries.		•		All Air Tools
8	When applying whip hoses or quick chuck on a tool, use pipe sealant to prevent damaging the housing.		•		All Air Tools
9	Always use the impact type of sockets that are designed for impact wrenches.		•		Wrench
10	If an air wrench fails to loosen a bolt within five seconds, use a larger wrench for replacement and apply penetrating oil before operation of the tool.				Wrench
11	Check to lubricate the clutch regularly. For example, a 3/8" air wrench should have 3/8 oz of lubricant in the clutch mechanism.		•		Wrench
12	Only use the proper wheel and pad for sanding and keep them in secure and correct connection.		•	•	Sander Grinder
13	Never use a sander as a grinder. Sander is only intended for sanding.		•		Sander Grinder
14	Always use accessories with a rated speed that is greater than or equal to the sander's speed.		•	•	Sander Grinder
15	Clean and lubricate the chuck jaw periodically to maintain the concentricity.		•		Drill
16	Use proper twist drills and reamers, and select proper drill speed to avoid the danger of breakage from high breakthrough torque.		•		Drill
17	Start drilling at lower speed and gradually increase the power to avoid kickback at breakthrough.		•		Drill



Super Hammer

1. Hammer Cage
2. New Hammer (Patented)
3. Hammer Pin
4. Anvil

Impact Mechanisms



Twin Hammer

1. Hammer Cage
2. Hammer
3. Hammer Pin
4. Anvil

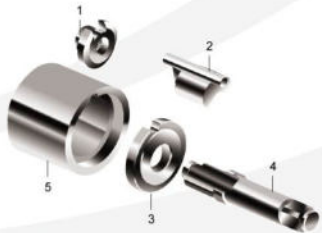

Pin Hammer

1. Cam
2. Pin Hammer
3. Cage Cover
4. Anvil
5. Hammer Cage

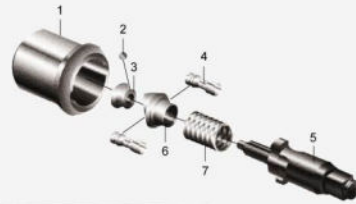

Pin Clutch

1. Hammer Cage
2. Steel Ball
3. Cam Foundation
4. Hammer Pin
5. Anvil
6. Cam
7. Spring

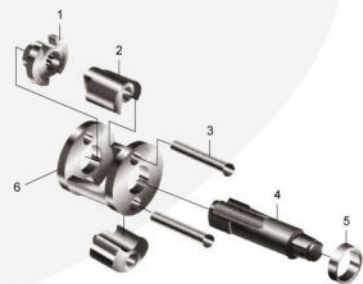

Double Hammer

1. Cage
2. Hammer Dog
3. Hammer Pin
4. Anvil
5. Anvil Bushing
6. Hammer Cage

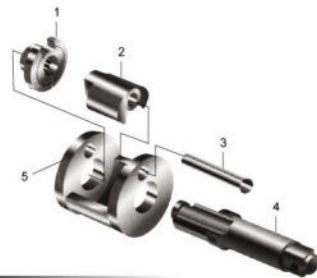

Rocking Dog

1. Cam
2. Hammer Dog
3. Hammer Pin
4. Anvil
5. Hammer Cage



MECHONEER® Series

Premium Series Impact Wrench

MECHONEER® Drive System features a new patent pending impact mechanism, reducing vibration by up to 40% and noise up to 10%, and increasing life by 80% and unbeatable power to weight ratio.

TOOLS FEATURES



40%
REDUCING
VIBRATION



10%
REDUCING
NOISE



80%
INCREASING
LIFE

A Hammer cage end plate retains the grease in the hammers & cage reducing wear

B Patented MECHONEER® pin-less/twin hammer clutch reduces wear and vibration

C Rotor spline connected to anvil eliminates misalignment and reduces wear and vibration

D Through-bolt motor assembly construction eliminates component misalignment reducing wear; and eliminates motor air leakage increasing performance

E Patented trigger mounted combined forward/reverse/power management switch provides convenient one hand operation

F Ergonomic handle design provides unmatched operator comfort

G Patented muffler reduces noise level of the tools



HOW IT WORKS

The patented MECHONEER® Drive System is a Hybrid twin hammer/pin-less mechanism that has fewer moving parts reducing vibration and wear. The clutch mechanism is sealed with a front end plate that retains grease within the mechanism reducing wear. The rear of the anvil is connected by a secondary spindle to

the rotor spline of the motor guaranteeing concentricity which reduces vibration and wear. The motor pack has a through-bolt that ensures concentricity and alignment of the rotor, end plates and cylinder — reducing wear and eliminating internal motor air leaks then can effect power.

HOW TO CHANGE THE TAB FROM RIGHT-HAND TO LEFT-HAND SIDE?



STEP 1

Push pin

STEP 2

Pull tab and insert to the other side



Patented trigger mounted combined forward/reverse/power management switch provides convenient one hand operation

MOTOR DESIGN

The air motor is a sub assembly is held together with a cap screw, ensuring no misalignment of the end plates — reducing end plate wear, while ensuring no loss of motor power due to air leakage.

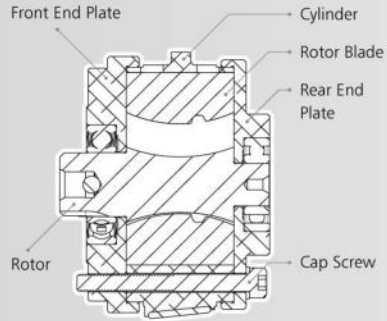

The steel ball reduces wear. The pin engages in a hole at the back of the anvil and also engages in a hole at the front of the rotor spline ensuring perfect concentricity between the rotor and MECHONEER® anvil.

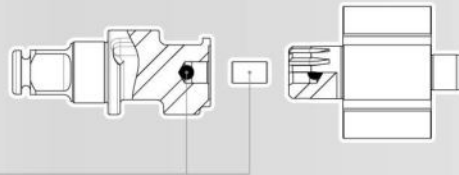

SUMMARY MECHONEER® BENEFITS

With no pins passing through the hammer cage, the cage is strengthened providing pin-less reliability with twin hammer blow frequency. The pin-less action, removal of pins and the concentricity with the rotor reduces vibration and further increases reliability. Sealing the mechanism with an end plate eliminates the characteristic of all twin hammer, rocking dog, pin-less hammer, jumbo hammer mechanisms; where the centrifugal force throws the grease to the inside of the hammer case, causing premature hammer and anvil wear.

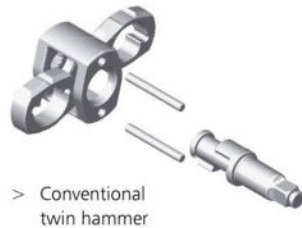

> Conventional twin hammer



> Conventional pin-less

DRIVE SYSTEM

The end plate seals with the cage preventing loss of grease

The anvil is driven by the twin hammers "twin hammer concept"

The hammers are driven by the cage "pin-less concept"

The cage is driven by the rotor spline "pin-less concept"

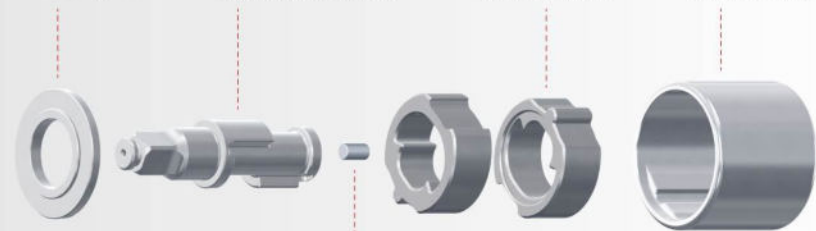

The pin engages in a hole at the back of the anvil and also engages in a hole at the front of the rotor spline ensuring perfect concentricity between the rotor and MECHONEER® anvil



TPT-2824
1" Impact Wrench

TPT-2824-L
with 7" extended anvil



TPT-2825-L
1" Impact Wrench

TPT-2825
with 1" short anvil

Model	SQ Drive		No Free Speed		Busting Torque Reverse		Net Weight		Overall Length		Noise (no load)	Average Air Cons. @ Load	Air Inlet NPTF	Hose Size
	inch	rpm	ft-lb	Nm	lb	kg	inch	mm	dBA	cfm	L/min	inch	inch	mm
TPT-2824	1"	4,300	2,300	3,120	14.9	6.8	9.6	244	103	10.6	300	1/2	1/2	13
TPT-2824-L	1"	4,300	2,300	3,120	16.9	7.7	15.0	380	103	10.6	300	1/2	1/2	13
TPT-2825	1"	6,000	2,500	3,390	18.7	8.5	13.4	340	108	12.0	340	1/2	1/2	13
TPT-2825-L	1"	6,000	2,500	3,390	20.9	9.5	20.7	507	108	12.0	340	1/2	1/2	13

MECHONEER® Series



TPT-2437
1/2" Impact Wrench



TPT-2224
1/2" Stubby Impact Wrench

Patented Trigger Design



STEP 1

Push pin

STEP 2

Pull tab and insert to the other side



TPT-2627
3/4" Impact wrench

TPT-2627-L
with 6" long anvil



Aluminum Impacts
Composite Impacts
Stubby Impacts

Air Impact Wrenches

The Air Impact Wrenches are one of the major products Tranmax offers. With the reliability and durability proven by customers and engineering expertise, they have been sold successfully on the market.

Model	SQ Drive	No Free Speed	Busting Torque Reverse		Net Weight		Overall Length		Noise (no load)	Average Air Cons. @ Load		Air Inlet NPTF	Hose Size	
	inch	rpm	ft-lb	Nm	lb	kg	inch	mm	dBa	cfm	L/min	inch	inch	mm
TPT-2224	1/2"	9,500	884	1,200	2.9	1.3	4.3	108.0	87	4.2	118	1/4	3/8	10
TPT-2437	1/2"	7,500	1,363	1,850	4.4	2.0	6.4	162.0	88.2	5.7	161	1/4	3/8	10
TPT-2627	3/4"	5,500	1,916	2,600	7.7	3.5	7.4	187.0	88.4	7.8	221	3/8	3/8	10
TPT-2627-L	3/4"	5,500	1,916	2,600	8.8	4.0	12.4	314.0	88.4	7.8	221	3/8	3/8	10

[Aluminum Impacts]



TPT-560B-SR-12
1-1/2" Impact Wrench, Super Hammer

Model	SQ Drive	No Free Speed	Max Torque Reverse		Net Weight		Overall Length		Noise (no load)	Average Air Cons. @ Load		Air Inlet NPTF	Hose Size	
	inch	rpm	ft-lb	Nm	lb	kg	inch	mm	dBA	cfm	L/min	inch	inch	mm
TPT-560B-SR-12	1-1/2	3,000	3,000	4,071	33.0	15.0	18.7	475	98.1	14.8	419	1/2	1/2	13
TPT-560B-SR-L	1	3,000	2,700	3,664	36.1	16.4	24.7	627	98.1	14.8	419	1/2	1/2	13
TPT-560B-SR	1	3,000	2,700	3,664	32.8	14.9	17.5	445	98.1	14.8	419	1/2	1/2	13
TPT-315P-L	1	4,500	2,300	3,123	24.0	10.9	19.8	503	103.4	12	340	1/2	1/2	13
TPT-315PX	1	4,500	2,300	3,123	21.1	9.6	13.7	347	103.4	12	340	1/2	1/2	13



TPT-560B-SR-L
1" Impact Wrench, Super Hammer, 9" anvil

TPT-560B-SR
with 1" short anvil



TPT-315PX-L
1" Impact Wrench, Super Hammer, 9" anvil

TPT-315PX
with 1" short anvil



TPT-315P-SR-L
1" Impact Wrench, Super Hammer, 8" anvil

TPT-315P-SR
with 1" Short Anvil

Model	SQ Drive	No Free Speed	Max Torque Reverse		Net Weight		Overall Length		Noise (no load)	Average Air Cons. @ Load		Air Inlet NPTF	Hose Size	
	inch	rpm	ft-lb	Nm	lb	kg	inch	mm	dBA	cfm	L/min	inch	inch	mm
TPT-315P-SR-L	1	4,000	2,200	2,985	23.5	10.7	21.1	536	102.6	12	340	1/2	1/2	13
TPT-315P-SR	1	4,000	2,200	2,985	20.5	9.3	15.0	380	102.6	12	340	1/2	1/2	13
TPT-315S-L	1	6,000	2,000	2,714	17.6	8.0	18.3	465	106.5	10.6	300	1/2	1/2	13
TPT-315S	1	6,000	2,000	2,714	15.2	6.9	11.9	303	106.5	10.6	300	1/2	1/2	13
TPT-318P-SR	1	3,500	2,000	2,714	21.1	9.6	11.8	300	101.6	11	311	1/2	1/2	13
TPT-318P-SR-L	1	3,500	2,000	2,714	24.0	10.9	18.0	456	101.6	11	311	1/2	1/2	13



TPT-315S-L
Compact 1" Impact Wrench, 8" Anvil, Super Hammer

TPT-315S
with 1" Short Anvil



TPT-318P-SR
1" Impact Wrench, Super Hammer

TPT-318P-SR-L
with 8" (203mm) extended anvil

[Aluminum Impacts]



TPT-275
3/4" Impact Wrench,
Pin Clutch



TPT-278D-SR
3/4" Impact Wrench,
Super Hammer
TPT-278D-SR-L
with 6" (152mm)
extended anvil

Model															
	inch	rpm	ft-lb	Nm	lb	kg	inch	mm	dBA	cfm	L/min	inch	inch	mm	mm
TPT-275	3/4	4,000	1,100	1,493	11.2	5.1	10.7	272	98	7.8	221	3/8	3/8	10	
TPT-278D-SR	3/4	5,000	1,250	1,696	9.7	4.4	8.5	216	99	8	226	3/8	3/8	10	
TPT-278D-SR-L	3/4	5,000	1,250	1,696	10.8	4.9	13.4	341	99	8	226	3/8	3/8	10	

Model															
	inch	rpm	ft-lb	Nm	lb	kg	inch	mm	dBA	cfm	L/min	inch	inch	mm	mm
TPT-271-D	3/4	4,800	800	1,086	10.8	4.9	9.7	246	92	7.2	204	1/4	3/8	10	
TPT-271-D-L	3/4	4,800	800	1,086	12.3	5.6	14.2	361	92	7.2	204	1/4	3/8	10	
TPT-270	3/4	4,800	800	1,086	9.9	4.5	9.5	241	97.1	7.2	204	1/4	3/8	10	



TPT-271-D
3/4" Impact Wrench,
Pin Clutch
TPT-271-D-L
with 6" (152mm)
extended anvil



TPT-270
3/4" Impact Wrench,
Pin Clutch

[Aluminum Impacts]



TPT-300-D
1/2" Impact Wrench,
Pin Clutch

TPT-300-D-L
with 2"(51mm)
extended anvil



TPT-303
1/2" Impact Wrench,
Twin Hammer

TPT-303-L
with 2"(51mm)
extended anvil



TPT-309
1/2" Impact Wrench,
Twin Hammer

TPT-309-L
with 2"(51mm)
extended anvil



TPT-303D-SR
1/2" Impact Wrench,
Super Hammer

TPT-303D-SR-L
with 2"(51mm)
extended anvil



TPT-302
1/2" Impact Wrench,
Pin Clutch



TPT-304-E
1/2" Impact Wrench,
Pin Clutch

TPT-304-E-L
with 2"(51mm)
extended anvil



TPT-305
1/2" Impact Wrench,
Twin Hammer

TPT-305-L
with 2"(51mm)
extended anvil



TPT-306
1/2" Impact Wrench,
Pin Clutch

TPT-306-L
with 2"(51mm)
extended anvil

Model														
	inch	rpm	ft-lb	Nm	lb	kg	inch	mm	dBA	cfm	L/min	inch	inch	mm
TPT-309	1/2	8,000	1,000	1,357	5.7	2.6	7.2	182	90	5.5	156	1/4	3/8	10
TPT-309-L	1/2	8,000	1,000	1,357	5.9	2.7	9.2	234	90	5.5	156	1/4	3/8	10
TPT-300-D	1/2	7,000	380	516	5.9	2.7	7.5	191	96.9	4.2	119	1/4	3/8	10
TPT-300-D-L	1/2	7,000	380	516	6.2	2.8	9.3	236	96.9	4.2	119	1/4	3/8	10
TPT-303	1/2	7,000	450	611	5.6	2.5	9.0	229	87.2	3.7	105	1/4	3/8	10
TPT-303-L	1/2	7,000	450	611	5.7	2.6	10.8	274	87.2	3.7	105	1/4	3/8	10
TPT-303D-SR	1/2	7,000	500	679	5.8	2.6	7.5	191	87.2	4.2	119	1/4	3/8	10
TPT-303D-SR-L	1/2	7,000	500	679	5.8	2.6	9.3	236	87.2	4.2	119	1/4	3/8	10

Model														
	inch	rpm	ft-lb	Nm	lb	kg	inch	mm	dBA	cfm	L/min	inch	inch	mm
TPT-302	1/2	7,000	320	434	5.0	2.3	7.3	185	93.2	3.7	105	1/4	3/8	10
TPT-304-E	1/2	7,000	450	611	5.5	2.5	7.3	185	91	4.2	119	1/4	3/8	10
TPT-304-E-L	1/2	7,000	450	611	5.7	2.6	9.7	246	91	4.2	119	1/4	3/8	10
TPT-305	1/2	7,000	500	679	5.8	2.6	7.6	193	86	4.6	130	1/4	3/8	10
TPT-305-L	1/2	7,000	500	679	5.9	2.7	9.4	238	86	4.6	130	1/4	3/8	10
TPT-306	1/2	8,000	400	543	5.3	2.4	7.8	198	88.1	4.6	130	1/4	3/8	10
TPT-306-L	1/2	8,000	400	543	5.5	2.5	9.8	249	88.1	4.6	130	1/4	3/8	10

[Aluminum Impacts]



TPT-245
3/8" Impact Wrench,
Twin Hammer
TPT-245-4
with 1/2" square drive

TPT-230
3/8" Impact Wrench,
Double Hammer



TPT-247
3/8" Impact Wrench,
Jumbo Hammer



[Stubby Impacts]



TPT-247B
1/2" Stubby Impact Wrench
Jumbo Hammer
Aluminum Housing



TPT-243D
1/2" Impact Wrench
Twin Hammer
Composite Housing



TPT-301D
1/2" Impact Wrench
Twin Hammer
Composite Housing



TPT-285D
Mini 3/4" Impact Wrench
Twin Hammer
Composite Housing

Model															
	inch	rpm	ft-lb	Nm	lb	kg	inch	mm	dBA	cfm	L/min	inch	inch	mm	
TPT-245	3/8	9,500	400	543	3.7	1.7	6.1	155	92	5	142	1/4	3/8	10	
TPT-245-4	1/2	9,500	450	611	3.7	1.7	6.1	155	92	5	142	1/4	3/8	10	
TPT-230	3/8	10,000	30	40	2.7	1.2	9.5	241	83	5	142	1/4	1/4	6.4	
TPT-247	3/8	10,000	180	244	3.0	1.4	6.4	163	88	2.8	79	1/4	3/8	10	

Model															
	inch	rpm	ft-lb	Nm	lb	kg	inch	mm	dBA	cfm	L/min	inch	inch	mm	
TPT-247B	1/2	9,500	775	1050	2.9	1.3	4.6	118	94.9	4.2	118	1/4	3/8	10	
TPT-243D	1/2	9,000	450	611	2.4	1.1	4.6	118	89.7	4.2	118	1/4	3/8	10	
TPT-301D	1/2	7,500	1,100	1,500	4.2	1.9	6.1	156	90.8	5.7	161	1/4	3/8	10	
TPT-285D	3/4	5,500	1,480	2,000	6.3	2.9	7.0	177	91.5	8	227	3/8	3/8	10	

[Composite Impacts]



TPT-318F-SR
1" Impact Wrench,
Super Hammer

TPT-318F-SR-L
with 8" (203mm) extended anvil



TPT-315F-SR-L
1" Impact Wrench, Super Hammer

TPT-315F-SR
with 1" short anvil



TPT-243V-SR
3/8" Impact Wrench,
Super Hammer

TPT-243V-SR-4
with 1/2" square drive



TPT-305V-SR
1/2" Impact Wrench
Super Hammer

TPT-305V-SR-L
with 2" (51mm) extended anvil



TPT-278V-SR
3/4" Impact Wrench,
Super Hammer

TPT-278V-SR-L
with 6" (152mm)
extended anvil



TPT-307D
1/2" Impact Wrench,
Super Hammer



TPT-272D
3/4" Impact Wrench,
Super Hammer

TPT-272D-L
with 6" (152mm)
extended anvil

Model	SQ Drive	No Free Speed	Max Torque Reverse		Net Weight		Overall Length		Noise (no load)	Average Air Cons. @ Load		Air Inlet NPTF		Hose Size	
	inch	rpm	ft-lb	Nm	lb	kg	inch	mm	dBa	cfm	L/min	inch	inch	mm	mm
TPT-318F-SR	1	4,000	1,800	2,443	15.8	7.2	9.9	251	97.9	14.5	410	1/2	1/2	13	
TPT-318F-SR-L	1	4,000	1,800	2,443	18.0	8.2	16.6	421	97.9	14.5	410	1/2	1/2	13	
TPT-315F-SR-L	1	4,000	1,800	2,443	18.7	8.5	21.7	550	92.3	14.5	410	1/2	1/2	13	
TPT-315F-SR	1	4,000	1,800	2,443	16.7	7.6	15.6	395	92.3	14.5	410	1/2	1/2	13	

Model	SQ Drive	No Free Speed	Max Torque Reverse		Net Weight		Overall Length		Noise (no load)	Average Air Cons. @ Load		Air Inlet NPTF		Hose Size	
	inch	rpm	ft-lb	Nm	lb	kg	inch	mm	dBa	cfm	L/min	inch	inch	mm	mm
TPT-243V-SR	3/8	12,000	320	434	2.6	1.2	6.5	165	85.3	7.4	209	1/4	3/8	10	
TPT-243V-SR-4	1/2	12,000	320	434	2.6	1.2	6.5	165	85.3	7.4	209	1/4	3/8	10	
TPT-305V-SR	1/2	7,500	1,000	1,357	4.4	2.0	7.6	193	91.9	10.2	289	1/4	3/8	10	
TPT-305V-SR-L	1/2	7,500	1,000	1,357	4.6	2.1	9.4	238	91.9	10.2	289	1/4	3/8	10	
TPT-278V-SR	3/4	5,500	1,400	1,900	7.5	3.4	9.0	229	90	9.5	269	3/8	3/8	10	
TPT-278V-SR-L	3/4	5,500	1,400	1,900	8.6	3.9	14.0	355	90	9.5	269	3/8	3/8	10	
TPT-307D	1/2	7,500	1,290	1,751	4.6	2.1	7.7	196	84.3	5.7	161	1/4	3/8	10	
TPT-272D	3/4	5,000	1,550	2,103	8.1	3.7	9.3	236	86.2	7.8	221	3/8	3/8	10	
TPT-272D-L	3/4	5,000	1,550	2,103	9.2	4.2	14.2	361	86.2	7.8	221	3/8	3/8	10	



Industrial Impact Tools

- TDW series
- TDW series - Oil-Bathed Type

The TDW Impact Tools are specially made for industrial applications. The design of the durable mechanism enhances customers' productivity and operations giving them a favorable solution for long working hours on assembly lines.

[TDW series]



TDW-767
Industrial 1/4" screwdriver

TDW-767S3
Industrial 3/8" impact wrench

TDW-777
Industrial 1/4" screwdriver

TDW-757
Industrial 1/4" screwdriver

TDW-757S3
Industrial 3/8" impact wrench

Model	Drive Size	Free Speed	Bolt Capacity	Working Torque (3 sec in forward)		Max. Torque (5 sec in reverse)		Weight		Overall Length		Noise (no load)	Air Cons.	Air Inlet	Hose Size	Vibration Level	
	inch	rpm	mm	Nm	ft-lb	Nm	ft-lb	lb	kg	inch	mm	dBA	l/min	inch	inch	mm	m/s ²
TDW-757	1/4" hex	8,000	M5-M6	10-45	7-33	88	65	2.2	1.0	7.8	201	92.4	80	1/4	1/4	10	5.6
TDW-757S3	3/8"	8,000	M6-M8	10-50	7-37	88	65	2.2	1.0	7.5	193	92.4	80	1/4	1/4	10	5.6
TDW-767	1/4" hex	8,000	M5-M6	10-45	7-33	88	65	2.5	1.2	6.6	168	86.2	95	1/4	1/4	10	5.3
TDW-767S3	3/8"	8,000	M6-M8	10-50	7-37	88	65	2.5	1.1	6.2	159	86.2	95	1/4	1/4	10	5.3
TDW-777	1/4" F/Hex	8,000	M6	10-40	7-30	79	58	2	0.9	6	155	84.6	80	1/4	1/4	10	5

Oil can & Slinger Ring are included

[TDW Series - Oil-Bathed Type]

TDW-278V
Industrial 3/4"
Impact Wrench,
Super Hammer
Composite Housing



TDW-243N
Industrial 1/2"
impact wrench,
Twin Hammer
Composite Housing



TDW-243C
Industrial 3/8"
impact wrench
Super Hammer
Composite Housing



TDW-243E
Industrial 1/2"
impact wrench,
Twin Hammer



TDW-307B
Industrial 1/2"
impact wrench
Super Hammer
Composite Housing

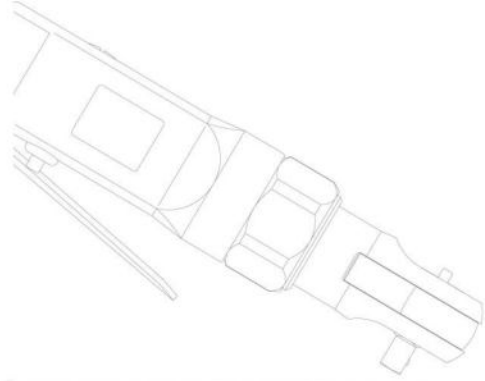

- Aluminum Ratchets
- Composite Ratchets

Air Ratchet Wrenches

Model																		
	inch	rpm	mm	Nm	ft-lb	Nm	ft-lb	lb	kg	inch	mm	dBA	l/min	inch	inch	mm	m/s ²	
TDW-243C	3/8	8,500	M12	50-240	37-177	403	297	2.9	1.3	6.6	170	81.8	210	1/4	3/8	10	7.3	
TDW-243C-4	1/2	8,500	M14	50-260	37-192	403	297	2.9	1.3	6.7	172	81.8	210	1/4	3/8	10	7.3	
TDW-243E	1/2	7,000	M12	50-200	37-147	403	297	3.1	1.4	7.4	188	90.5	140	1/4	3/8	10	6.9	
TDW-243N	1/2	8,000	M12	50-220	37-162	280	206	2.6	1.2	5.3	135	84.1	118	1/4	3/8	10	7.8	
TDW-307B	1/2	7,000	M18	200-500	147-368	1,080	796	5.1	2.3	8.0	204	86.6	161	1/4	3/8	10	9.4	
TDW-278V	3/4	5,000	M22	400-900	295-663	1,894	1,396	8.8	4.0	9.5	244	86.1	221	3/8	3/8	13	10.8	
TDW-315S-L	1	5,000	M32	500-1500	368-1105	1,964	1,447	18.5	8.4	20.5	525	93.3	300	1/2	1/2	13	17.7	
TDW-315S	1	5,000	M32	500-1500	368-1105	1,964	1,447	16.1	7.3	14.4	370	93.3	300	1/2	1/2	13	17.7	

Oil can & Slinger Ring are included

TDW-315S-L
Industrial 1"
Impact wrench
Super Hammer



[Aluminum Ratchets]



TPT-217
3/8" Ratchet Wrench
TPT-217-4
with 1/2" square drive



TPT-219
1/2" Heavy Duty
Ratchet Wrench



TPT-220-3
3/8" Mini Ratchet Wrench
(2 in 1)



TPT-220-3R
3/8" Mini Ratchet Wrench
with revolving head

Model	SQ Drive		Free Speed		Max Torque Reverse		Net Weight		Overall Length		Noise Level	Average Air Cons. @ Load		Air Inlet NPTF	Hose Size	
	inch	rpm	ft-lb	Nm	lb	kg	inch	mm	dBA	cfm	L/min	inch	inch	mm		
TPT-217	3/8	160	55	75	2.6	1.2	10.0	254	93	8.5	240	1/4	3/8	10		
TPT-217-4	1/2	160	55	75	2.6	1.2	10.0	254	93	8.5	240	1/4	3/8	10		
TPT-219	1/2	150	90	122	4.4	2.0	14.2	360	103	8.0	225	1/4	3/8	10		
TPT-220-3	3/8	260	20	27	0.9	0.4	4.7	120	87	2.6	74	1/4	3/8	10		
TPT-220-3R	3/8	260	20	27	0.9	0.4	4.7	120	87	2.6	74	1/4	3/8	10		



TPT-221
1/4" Ratchet Wrench
TPT-221-3
with 3/8" square drive



TPT-222
1/4" Ratchet Wrench
TPT-222-3
with 3/8" square drive



TPT-225
3/8" Heavy Duty Ratchet Wrench
TPT-225-4
with 1/2" square drive



TPT-226
3/8" Heavy Duty Ratchet Wrench
TPT-226-4
with 1/2" square drive

Model	SQ Drive		Free Speed		Max Torque Reverse		Net Weight		Overall Length		Noise Level	Average Air Cons. @ Load		Air Inlet NPTF	Hose Size	
	inch	rpm	ft-lb	Nm	lb	kg	inch	mm	dBA	cfm	L/min	inch	inch	mm		
TPT-221	1/4	220	26	35	1.3	0.6	6.9	174	83	3.9	110	1/4	3/8	10		
TPT-221-3	3/8	220	26	35	1.3	0.6	6.9	174	83	3.9	110	1/4	3/8	10		
TPT-222	1/4	260	20	27	1.1	0.5	5.1	130	86	3.9	110	1/4	3/8	10		
TPT-222-3	3/8	260	20	27	1.1	0.5	5.1	130	86	3.9	110	1/4	3/8	10		
TPT-225	3/8	160	60	81	2.6	1.2	10.2	260	93	9.5	269	1/4	3/8	10		
TPT-225-4	1/2	160	60	81	2.6	1.2	10.2	260	93	9.5	269	1/4	3/8	10		
TPT-226	3/8	160	55	75	2.4	1.1	10.6	270	93	9.0	255	1/4	3/8	10		
TPT-226-4	1/2	160	55	75	2.4	1.1	10.6	270	93	9.0	255	1/4	3/8	10		

[Aluminum Ratchets]

TPT-202
3/8" Impact Ratchet Wrench
TPT-202-4
with 1/2" square drive



TPT-201
1/4" Impact Ratchet Wrench
TPT-201-3
with 3/8" square drive

Model	SQ Drive	No Free Speed	Max Torque Reverse		Net Weight		Overall Length		Noise Level	Average Air Cons. @ Load		Air Inlet NPTF		Hose Size
	inch	rpm	ft-lb	Nm	lb	kg	inch	mm	dBA	cfm	L/min	inch	inch	mm
TPT-201	1/4	500	40	54	1.6	0.7	7.5	190	82.4	3.1	88	1/4	3/8	10
TPT-201-3	3/8	500	40	54	1.6	0.7	7.5	190	82.4	3.1	88	1/4	3/8	10
TPT-202	3/8	500	81	110	3.1	1.4	10.9	278	92.9	4.0	113	1/4	3/8	10
TPT-202-4	1/2	500	81	110	3.1	1.4	10.9	278	92.9	4.0	113	1/4	3/8	10

TPT-223
Inline Ratchet Wrench



TPT-224
Inline Ratchet Wrench



Model	Bolt Capacity	No Free Speed	Max Torque		Net Weight		Overall Length		Noise Level	Average Air Cons. @ Load		Air Inlet NPTF		Hose Size
	mm	rpm	ft-lb	Nm	lb	kg	inch	mm	dBA	cfm	L/min	inch	inch	mm
TPT-223	M6-M12	180	7	10	2.9	1.3	11.8	300	86	4.5	127	1/4	1/4	6.4
TPT-224	M10-M14	250	18	25	4.2	1.9	13.1	332	87	7.5	212	1/4	1/4	6.4

[Composite Ratchets]



TPT-221F
1/4" Ratchet Wrench
TPT-221F-3
with 3/8" square drive

TPT-217F
3/8" Ratchet Wrench
TPT-217F-4
with 1/2" square drive



TPT-223F-B
1/4" Ratchet Wrench
TPT-223F-B3
with 3/8" square drive



Model	SQ Drive	No Free Speed	Max Torque		Net Weight		Overall Length		Noise (no load)	Average Air Cons. @ Load		Air Inlet NPTF		Hose Size
	inch	rpm	ft-lb	Nm	lb	kg	inch	mm	dBA	cfm	L/min	inch	inch	mm
TPT-221F	1/4	230	26	35	1.3	0.6	7.6	194	75.9	1.9	55	1/4	3/8	10
TPT-221F-3	3/8	230	26	35	1.3	0.6	7.6	194	75.9	1.9	55	1/4	3/8	10
TPT-217F	3/8	160	60	81	2.0	0.9	10.6	270	81.7	6.0	170	1/4	3/8	10
TPT-217F-4	1/2	160	60	81	2.0	0.9	10.6	270	81.7	6.0	170	1/4	3/8	10
TPT-223F-B	1/4	250	26	35	1.9	0.9	9.4	238	85	1.9	55	1/4	3/8	10
TPT-223F-B3	3/8	250	26	35	1.9	0.9	9.4	238	85	1.9	55	1/4	3/8	10

Head Cover not included

Accessories for Air Ratchets

216-039 Head Cover

Apply to: TPT-217, TPT-217F

222F-046 Head Cover

Apply to: TPT-221, TPT-221F, TPT-223F-B(-B3)

201-047 Head Cover

Apply to: TPT-201(-3)

218F-046B Head Cover

Apply to: TPT-202(-4)



[Sockets]



1/2" **01-0231**
 Deep Socket Set (4 pcs)
 17mm / 19mm / 21mm / 22mm (80mmL)
 Color Socket also available



1/2" **01-0226**
 Socket Set (3 pcs)
 17mm / 19mm / 21mm (39mmL)
 Color Socket also available



1/2" **01-0233**
 Thin Wall Wheel Socket Set (3 pcs)
 17mm / 19mm / 21mm (85mmL)



1/2" **01-0234**
 Deep Socket Set (3 pcs)
 17mm / 19mm / 21mm (78mmL)



1/2" **01-0235**
 Thin Wall Wheel Socket kit
 17mm / 19mm / 21mm



1/2" **01-0236**
 Thin Wall Wheel Socket kit
 15mm / 17mm / 19mm / 21mm



3/4" **01-0263**
 Socket Set (4 pcs)
 17mm / 19mm / 21mm / 27mm



1" **01-0281**
 Socket Set (4 pcs)
 21mm / 27mm / 38mm / 41mm



Air Grinders and Cutting Tools

- Angle Grinders
- Die Grinders
- Composite Grinders
- Cutting Tools

[Corner Grinder & Angle Grinders]



TPT-623F
4" Corner Grinder w/ rotatable guard
Wheel Size: 100x10 mm

Model															
	inch	rpm	hp	KW	lb	kg	inch	mm	dBa	cfm	L/min	inch	inch	mm	
TPT-623F	4	17,000	1.0	0.75	3.1	1.4	15.3	390	93.3	13.0	370	1/4	3/8	10	



TPT-507
4" Angle Grinder

TPT-507-B
with 5" wheel



TPT-801
4" Angle Grinder

TPT-801-B
5" Angle Grinder



TPT-510-B
5" Angle Grinder

TPT-510R-B
with Swivel Guard



TPT-507H
4" Angle Grinder

TPT-507H-B
with 5" wheel

Model															
	mm	rpm	hp	KW	lb	kg	inch	mm	dBa	cfm	L/min	inch	inch	mm	
TPT-801	M10 x 1.5P	11,000	1.0	0.75	4.4	2.0	8.8	224	93.3	5.3	150	1/4	3/8	10	
TPT-801-B	M14 x 2P	11,000	1.0	0.75	4.4	2.0	8.8	224	92	5.3	150	1/4	3/8	10	
TPT-510-B	M14 x 2P	11,000	0.7	0.52	3.9	1.8	9.0	230	89.6	4.9	127	1/4	3/8	10	
TPT-510R-B	M14 x 2P	11,000	0.7	0.52	3.9	1.8	9.0	230	89.6	4.9	127	1/4	3/8	10	

Grinding Disc not included; Imperial spindle sizes are available.
TPT-801(-B) is also available to fit the cutting disc by only changing the flange. Please refer to the exploded view for extra parts ordering.

Model															
	mm	rpm	hp	KW	lb	kg	inch	mm	dBa	cfm	L/min	inch	inch	mm	
TPT-507	M10 x 1.5P	11,000	0.6	0.4	3.9	1.8	8.9	226	86	17.3	490	1/4	3/8	10	
TPT-507-B	M14 x 2P	11,000	0.6	0.4	3.9	1.8	8.9	226	86	17.3	490	1/4	3/8	10	
TPT-507H	M8 x 1.25P	10,900	0.8	0.6	4.4	2.0	9.7	246	86	13.4	380	1/4	3/8	10	
TPT-507H-B	M14 x 2P	10,900	0.8	0.6	4.4	2.0	9.7	246	86	13.4	380	1/4	3/8	10	

Grinding Disc not included; Imperial spindle sizes are available.

[Angle Grinders]



TPT-507R
4" Angle Grinder
Roller Switch
TPT-507R-B
with 5" disc



TPT-508
7" Angle Grinder, Spline



TPT-508H
7" Angle Grinder



TPT-509
4" Angle 100° Grinder
TPT-509-B
with 5" disc



TPT-910
7" Vertical Grinder



TPT-911
9" Vertical Grinder

[Die Grinders]



TPT-501A
1/4" Mini Angle Die Grinder



TPT-501
1/4" Mini Die Grinder

TPT-521
1/4" Die Grinder



TPT-522
1/4" Die Grinder



TPT-523
Stripping Tool



TPT-524
1/4" Die Grinder Extended



Model	Spindle Thread		No Free Speed		Rated Power		Net Weight		Overall Length		Noise Level	Average Air Cons. @ Load	Air Inlet NPTF	Hose Size
	mm	rpm	hp	KW	lb	kg	inch	mm	dBA	cfm	L/min	inch	inch	mm
TPT-507R	M10 x 1.5P	11,000	0.6	0.4	3.3	1.5	8.9	226	86	17.3	490	1/4	3/8	10
TPT-507R-B	M14 x 2P	11,000	0.6	0.4	3.3	1.5	8.9	226	86	17.3	490	1/4	3/8	10
TPT-508	-	7,000	1.2	0.9	7.0	3.2	13.5	343	101	9.0	255	3/8	3/8	10
TPT-508H	M14 x 2P	7,600	2.0	1.5	8.4	3.8	11.8	300	101	9.0	255	3/8	3/8	10
TPT-509	M10 x 1.5P	10,000	1.2	0.9	3.1	1.4	8.2	210	86	5.0	142	1/4	3/8	10
TPT-509-B	M14 x 2P	10,000	1.2	0.9	3.1	1.4	8.2	210	85	5.0	142	1/4	3/8	10
TPT-910	M14 x 2P	7,000	2.3	1.7	9.2	4.2	13.4	340	84	16.3	461	1/2	3/8	10
TPT-911	M14 x 2P	6,000	2.3	1.7	9.7	4.4	13.4	340	77	16.3	461	1/2	3/8	10

Grinding Disc not included; Imperial spindle sizes are available.

Model	Collet Size		No Free Speed		Rated Power		Net Weight		Overall Length		Noise (no load)	Average Air Cons. @ Load	Air Inlet NPTF	Hose Size	
	inch	mm	rpm	hp	kw	lb	kg	inch	mm	dBA	cfm	L/min	inch	inch	mm
TPT-501A	1/4	6	22,000	0.3	0.2	1.1	0.5	5.6	142	83.5	9.5	270	1/4	3/8	10
TPT-501	1/4	6	25,000	0.3	0.2	0.9	0.4	5.6	142	81.3	9.5	270	1/4	3/8	10
TPT-521	1/4	6	20,000	0.5	0.4	1.5	0.7	7.0	177	84.4	9.9	280	1/4	3/8	10
TPT-522	1/4	6	3,500	0.5	0.4	2.0	0.9	8.6	218	85.8	9.9	280	1/4	3/8	10
TPT-523	N/A		2,000	0.5	0.4	2.0	0.9	8.6	218	83.5	9.9	280	1/4	3/8	10
TPT-524	1/4	6	20,000	0.5	0.4	2.2	1.0	12.6	319	86	9.9	280	1/4	3/8	10

[Die Grinders]



TPT-502H
1/8" Micro Die Grinder



TPT-503H
1/8" Micro Die Grinder



TPT-504H
1/8" Micro Die Grinder



TPT-505H
1/8" Angle Surface Grinder



TPT-506
Turbo Lab Grinder(Liner)
TPT-506-03
with stroke 0.3mm
TPT-506-07
with stroke 0.7mm
TPT-506-12
with stroke 1.2mm

TPT-506S
Turbo Grinder(Swing)
TPT-506S-03
with stroke 0.3mm
TPT-506S-07
with stroke 0.7mm
TPT-506S-12
with stroke 1.2mm

Model	Collet Size		Stroke Size mm	No Free Speed rpm	Rated Power		Net Weight		Overall Length		Noise Level dBA	Average Air Cons. @ Load		Air Inlet NPTF	Hose Size		
	inch	mm			hp	kw	lb	kg	inch	mm		cfm	L/min		inch	inch	mm
TPT-502H	1/8	3	-	60,000	0.2	0.1	0.4	0.2	5.3	135	82	4.9	140	1/4	1/4	6.4	
TPT-503H	1/8	3	-	65,000	0.2	0.1	0.2	0.1	6.5	165	84	4.2	120	1/4	1/4	6.4	
TPT-504H	1/8	3	-	80,000	0.2	0.1	0.7	0.3	6.3	160	84	5.7	160	1/4	1/4	6.4	
TPT-505H	1/8	3	-	23,500	0.2	0.1	0.4	0.2	5.5	140	84	4.2	120	1/4	1/4	6.4	
TPT-506-03	-	-	0.3	60,000	-	-	0.4	0.2	7.3	185	84	4.2	120	1/4	1/4	6.4	
TPT-506-07	-	-	0.7	30,000	-	-	0.4	0.2	7.3	185	84	4.2	120	1/4	1/4	6.4	
TPT-506-12	-	-	1.2	20,000	-	-	0.4	0.2	7.3	185	84	4.2	120	1/4	1/4	6.4	
TPT-506S-03	-	-	0.3	55,000	-	-	0.4	0.2	7.3	185	84	4.2	120	1/4	1/4	6.4	
TPT-506S-07	-	-	0.7	20,000	-	-	0.4	0.2	7.3	185	84	4.2	120	1/4	1/4	6.4	
TPT-506S-12	-	-	1.2	10,000	-	-	0.4	0.2	7.3	185	84	4.2	120	1/4	1/4	6.4	

Sanding Disc Not Included

TPT-525
High Speed Tire Buffer



TPT-526
Low Speed Tire Buffer



Model	Spindle Thread	No Free Speed	Rated Power		Net Weight		Overall Length		Noise (no load) dBA	Average Air Cons. @ Load		Air Inlet NPTF	Hose Size	
			hp	kw	lb	kg	inch	mm		cfm	L/min		inch	mm
TPT-525	3/8-24	20,000	0.5	0.4	2.0	0.9	9.2	234	83.3	9.9	280	1/4	3/8	10
TPT-526	3/8-24	3,500	0.5	0.4	2.2	1.0	9.6	243	84.9	9.9	280	1/4	3/8	10



TPT-530
Heavy Duty Wheel Grinder



TPT-533
6" Super Duty Wheel Grinder



533-045



513-001

Accessories for Die Grinders			
Part No.		Apply to	
533-045	6" Sanding Disc	TPT-533	
513-001	Eraser Wheel	TPT-523, TPT-523F	

Model	Wheel / Disc	No Free Speed	Rated Power		Net Weight		Overall Length		Noise (no load) dBA	Average Air Cons. @ Load		Air Inlet NPTF	Hose Size	
			hp	kw	lb	kg	inch	mm		cfm	L/min		inch	mm
TPT-530	3	20,000	0.5	0.4	2.2	1	7.9	200	84.7	15.2	430	1/4	3/8	10
TPT-533	6	5,700	3.2	2.38	11.4	5.2	19.7	500	87	26.9	760	1/4	3/8	10

[Composite Die Grinders - 1 HP Series]



TPT-651F
1/4" Die Grinder



TPT-650F
3" Cut Off Tool



TPT-651FA
1/4" Angle Die Grinder



TPT-651FA-S
3" Angle Polisher



TPT-654F
1/4" Extended Die Grinder

HIGHLIGHTS

Precise Ductile Cast Iron cylinder with fine machining and inner grinding reduces the friction to the least.

Unique Kevlar Blade gives better wear resistance.

Housing Rubber cover provides more comfortable operation.

Precise collet gives better run out.



German made hi-end bearings in ends of the motor set provides good support of the rotor.

Sensitive valve system.

Safety Trigger avoids accidental motion.

Rear exhaust cap is able to connect the exhaust hose.

Model	Collet Size		Free Speed rpm	Rated Power		Net Weight		Overall Length		Noise Level dBA	Average Air Cons. @ Load		Air Inlet NPTF	Hose Size	
	inch	mm		hp	kw	lb	kg	inch	mm		cfm	L/min		inch	inch
TPT-650F	3 (NA)		20,000	1.0	0.75	2.2	1.0	8.9	227	88.7	13.0	370	1/4	3/8	10
TPT-651F	1/4	6	20,000	1.0	0.75	1.8	0.8	8.2	207	88.1	13.0	370	1/4	3/8	10
TPT-651FA	1/4	6	15,000	1.0	0.75	2.4	1.1	8.9	227	85.6	13.0	370	1/4	3/8	10
TPT-651FA-S	3	76	15,000	1.0	0.75	2.4	1.1	9.8	250	85.6	13.0	370	1/4	3/8	10
TPT-654F	1/4	6	20,000	1.0	0.75	2.7	1.2	13.7	348	85.7	13.0	370	1/4	3/8	10

[Composite Die Grinders]



TPT-521F
1/4" Die Grinder

TPT-522F
1/4" Die Grinder



TPT-523F
Stripping Tool

TPT-542A
1/4" Angle 97° Die Grinder



TPT-524F
1/4" Extended Die Grinder

Model	Collet Size		No Free Speed	Rated Power		Net Weight		Overall Length		Noise (no load)	Average Air Cons. @ Load		Air Inlet NPTF	Hose Size	
	inch	mm		hp	KW	lb	kg	inch	mm		cfm	L/min		inch	inch
TPT-521F	1/4	6	20,000	0.5	0.4	1.3	0.6	7.1	180	85	9.9	280	1/4	3/8	10
TPT-522F	1/4	6	3,500	0.5	0.4	2.0	0.9	8.8	223	83.5	9.9	280	1/4	3/8	10
TPT-523F	-	-	2,000	0.5	0.4	2.0	0.9	8.5	217	85	9.9	280	1/4	3/8	10
TPT-524F	1/4	6	20,000	0.5	0.4	2.2	1.0	12.6	319	86	9.9	280	1/4	3/8	10
TPT-542A	1/4	6	22,000	0.4	0.3	1.1	0.5	6.7	170	80	17.3	490	1/4	3/8	10



TPT-535B
1/4" Die Grinder



TPT-536B
1/4" Die Grinder

Model	Collet Size		No Free Speed	Rated Power		Net Weight		Overall Length		Noise Level	Average Air Cons. @ Load		Air Inlet NPTF	Hose Size	
	inch	mm		rpm	hp	KW	lb	kg	inch		mm	cfm		L/min	inch
TPT-535B	1/4	6	25,000	0.3	0.2	0.9	0.4	6.3	159	86	21.0	594	1/4	3/8	10
TPT-536B	1/4	6	25,000	0.3	0.2	1.1	0.5	7.8	199	86	21.0	594	1/4	3/8	10
TPT-537B	1/4	6	20,000	0.3	0.2	1.1	0.5	6.0	153	86	21.0	594	1/4	3/8	10
TPT-538B	1/4	6	15,000	0.3	0.2	1.1	0.5	6.7	169	86	21.0	594	1/4	3/8	10



TPT-537B
1/4" Angle Die Grinder



TPT-538B
1/4" Angle Die Grinder

[Cutting Tools]



TPT-472
Air File



TPT-473
Air File

Model	Stroke Speed	Piston Stroke	Net Weight		Overall Length		Noise Level	Average Air Cons. @ Load		Air Inlet NPTF		Hose Size
	bpm	mm	lb	kg	inch	mm	dBA	cfm	L/min	inch	inch	mm
TPT-472	3,700	10	2.2	1.0	9.2	234	90	1.7	48	1/4	3/8	10
TPT-473	3,400	5	1.1	0.5	6.9	174	86	7.1	200	1/4	3/8	10

TPT-501F
1/4" Mini Die Grinder



TPT-501FA
1/4" Mini Angle Die Grinder



TPT-526F
Low Speed Tire Buffer



TPT-525F
High Speed Tire Buffer



TPT-530FB
Air Cut-off Tool



TPT-640C-K
TPT-640-K
Air Body Saw Kit



TPT-640
Air Body Saw



TPT-640C
Air Body Saw (Rear Exhaust)



TPT-690
Air Nibbler

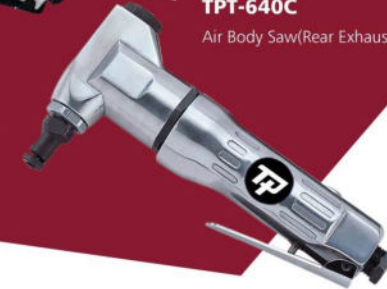

Model	Collet Size		Free Speed	Rated Power		Net Weight		Overall Length		Noise Level	Average Air Cons. @ Load		Air Inlet NPTF		Hose Size
	inch	mm	rpm	hp	KW	lb	kg	inch	mm	dBA	cfm	L/min	inch	inch	mm
TPT-501F	1/4	6	25,000	0.3	0.2	0.9	0.4	5.6	142	86	9.5	270	1/4	3/8	10
TPT-501FA	1/4	6	22,000	0.3	0.2	1.1	0.5	5.6	142	86	9.5	270	1/4	3/8	10

Model	Thread Size	Free Speed	Rated Power		Net Weight		Overall Length		Noise Level	Average Air Cons. @ Load		Air Inlet NPTF		Hose Size
	inch	rpm	hp	KW	lb	kg	inch	mm	dBA	cfm	L/min	inch	inch	mm
TPT-525F	3/8-24	20,000	0.5	0.4	2.0	0.9	9.2	234	86	9.9	280	1/4	3/8	10
TPT-526F	3/8-24	3,500	0.5	0.4	2.2	1.0	9.6	243	86	9.9	280	1/4	3/8	10

Model	Disk Size	Free Speed	Rated Power		Net Weight		Overall Length		Noise Level	Average Air Cons. @ Load		Air Inlet NPTF		Hose Size
	inch	rpm	hp	KW	lb	kg	inch	mm	dBA	cfm	L/min	inch	inch	mm
TPT-530FB	3	20,000	0.5	0.4	2.2	1	7.5	190	85	15.2	430	1/4	3/8	10

Model	Stroke Speed	Piston Stroke	Net Weight		Overall Length		Noise Level	Average Air Cons. @ Load		Air Inlet NPTF		Hose Size
	bpm	mm	lb	kg	inch	mm	dBA	cfm	L/min	inch	inch	mm
TPT-640	9,500	10	1.3	0.6	11.0	280	91	7.8	220	1/4	3/8	10
TPT-640C	9,500	10	1.5	0.7	11.8	300	83	7.8	220	1/4	3/8	10
TPT-690	3,500	-	1.8	0.8	7.7	195	90	12.7	360	1/4	3/8	10



■ Sanders
Air Finishing Tools

[Random Orbital Sanders]



TPT-435

3" Random Orbital Sanders

Model	Pad Diameter		Orbital Diameter		Free Speed		Net Weight		Noise Level	Average Air Cons. @ Load		Air Inlet NPTF	Hose Size		Vac Type
	inch	mm	inch	mm	rpm	lb	kg	dBA	cfm	L/min	inch	inch	mm		
TPT-435N-3H	3	76.2	3/32	2.5	10,000	1.5	0.7	83	19.1	540	1/4	3/8	10	NV	
TPT-435C-3H	3	76.2	3/32	2.5	10,000	1.5	0.7	83	19.1	540	1/4	3/8	10	CV	



TPT-441



TPT-434



TPT-436

5" Random Orbital Sanders

Model	Pad Diameter		Orbital Diameter		Free Speed		Net Weight		Noise Level	Average Air Cons. @ Load		Air Inlet NPTF	Hose Size		Vac Type
	inch	mm	inch	mm	rpm	lb	kg	dBA	cfm	L/min	inch	inch	mm		
TPT-441N-5H	5	127	3/16	5	12,000	1.8	0.8	75	15.5	439	1/4	3/8	10	NV	
TPT-441S-5H	5	127	3/16	5	12,000	2.0	0.9	95	15.5	439	1/4	3/8	10	SV	
TPT-441C-5H	5	127	3/16	5	12,000	2.0	0.9	78	15.5	439	1/4	3/8	10	CV	
TPT-434N-5H	5	127	3/16	5	12,000	1.5	0.7	75	15.5	439	1/4	3/8	10	NV	
TPT-434S-5H	5	127	3/16	5	12,000	1.5	0.7	93	15.5	439	1/4	3/8	10	SV	
TPT-434C-5H	5	127	3/16	5	12,000	1.5	0.7	82	15.5	439	1/4	3/8	10	CV	
TPT-436N-5H	5	127	3/16	5	10,000	2.1	1.0	82	15.5	439	1/4	3/8	10	NV	
TPT-436S-5H	5	127	3/16	5	10,000	2.1	1.0	82	15.5	439	1/4	3/8	10	SV	
TPT-436C-5H	5	127	3/16	5	10,000	2.1	1.0	82	15.5	439	1/4	3/8	10	CV	

NV=Non-Vacuum; SV=Self Vacuum; CV=Central Vacuum

[Random Orbital Sanders]



TPT-441



TPT-437



TPT-434



TPT-446

TPT-447

6" Random Orbital Sanders

Model	Pad Diameter		Orbital Diameter		No Free Speed		Net Weight		Noise Level	Average Air Cons. @ Load		Air Inlet NPTF	Hose Size		Vac Type
	inch	inch	inch	mm	rpm	lb	kg	dBA	cfm	L/min	inch	inch	mm		
TPT-441N-6H	6	3/16	5	12,000	1.8	0.8	82	15.5	439	1/4	3/8	10	NV		
TPT-441S-6H	6	3/16	5	12,000	1.8	0.8	82	15.5	439	1/4	3/8	10	SV		
TPT-441C-6H	6	3/16	5	12,000	1.8	0.8	82	15.5	439	1/4	3/8	10	CV		
TPT-434N-6H	6	3/16	5	12,000	1.5	0.7	82	15.5	439	1/4	3/8	10	NV		
TPT-434S-6H	6	3/16	5	12,000	1.5	0.7	82	15.5	439	1/4	3/8	10	SV		
TPT-434C-6H	6	3/16	5	12,000	1.5	0.7	82	15.5	439	1/4	3/8	10	CV		
TPT-437N-6H	6	3/16	5	10,000	2.1	1.0	82	15.5	439	1/4	3/8	10	NV		
TPT-437S-6H	6	3/16	5	10,000	2.1	1.0	82	15.5	439	1/4	3/8	10	SV		
TPT-437C-6H	6	3/16	5	10,000	2.1	1.0	82	15.5	439	1/4	3/8	10	CV		

6" Random Orbital Sanders

Model	Pad Diameter		Orbital Diameter		No Free Speed		Net Weight		Noise Level	Average Air Cons. @ Load		Air Inlet NPTF	Hose Size		Vac Type
	inch	inch	inch	mm	rpm	lb	kg	dBA	cfm	L/min	inch	inch	mm		
TPT-446N-6H	6	3/16	5	9,000	2.6	1.2	80	15.7	445	1/4	3/8	10	NV		
TPT-446S-6H	6	3/16	5	9,000	2.6	1.2	80	15.7	445	1/4	3/8	10	SV		
TPT-446C-6H	6	3/16	5	9,000	2.6	1.2	80	15.7	445	1/4	3/8	10	CV		
TPT-447N-6H	6	3/8	10	9,000	2.6	1.2	80	15.7	445	1/4	3/8	10	NV		
TPT-447S-6H	6	3/8	10	9,000	2.6	1.2	80	15.7	445	1/4	3/8	10	SV		
TPT-447C-6H	6	3/8	10	9,000	2.6	1.2	80	15.7	445	1/4	3/8	10	CV		

NV=Non-Vacuum; SV=Self Vacuum; CV=Central Vacuum

[Palm Sanders]

TPT-430
Palm Sander



Model	Pad Size	Orbital Diameter	No Free Speed	Net Weight		Noise (no load)	Average Air Cons. @ Load		Air Inlet NPTF	Hose Size		Vac Type
	mm	mm	rpm	lb	kg	dBA	cfm	L/min	inch	inch	mm	
TPT-430	100 x 110	1.6	20,000	1.1	0.5	80	1.0	28	1/4	3/8	10	NV

[Mini Sanders/Polishers]

TPT-411
2" Mini Orbital Sander



TPT-413
3" Mini Polisher



TPT-414
3" Mini Grinder



TPT-416
3" Mini Polisher



TPT-417
Finger Sander
*Pad Thread 5/16"-24

[Jitterbug Sanders]

TPT-431
Jitterbug Sander



TPT-432
Tri-Form Sander



TPT-442
Jitterbug Sander



TPT-445
2-Hand Jitterbug Sander



Model	Pad Size	Orbital Diameter	No Free Speed	Net Weight		Noise Level	Average Air Cons. @ Load		Air Inlet NPTF	Hose Size		Vac Type
	mm	mm	rpm	lb	kg	dBA	cfm	L/min	inch	inch	mm	
TPT-431	100 x 110	2.5	11,000	2.0	0.9	82	15.9	450	1/4	3/8	10	NV
TPT-432	125 x 95	5	11,000	1.8	0.8	82	15.9	450	1/4	3/8	10	NV
TPT-442	100 x 180	3.2	8,500	2.6	1.2	80	15.9	450	1/4	3/8	10	NV
TPT-445	100 x 180	5	7,500	3.3	1.5	88	15.9	450	1/4	3/8	10	NV

NV=Non-Vacuum; SV=Self Vacuum; CV=Central Vacuum

Model	Pad/ Disc Size	Orbital Diameter	No Free Speed	Net Weight		Overall Length		Noise Level	Average Air Cons. @ Load		Air Inlet NPTF	Hose Size	
	inch	mm	rpm	lb	kg	inch	mm	dBA	cfm	L/min	inch	inch	mm
TPT-411	2	3	15,000	1.5	0.7	6.3	160	82	21.2	600	1/4	3/8	10
TPT-413	3	1.5	2,500	1.5	0.7	6.3	160	82	21.2	600	1/4	3/8	10
TPT-414	3	3	15,000	1.5	0.7	6.3	160	82	21.2	600	1/4	3/8	10
TPT-416	3	0.75	2,500	1.8	0.8	6.3	160	80	21.2	600	1/4	3/8	10
TPT-417	-	3	13,000	1.8	0.8	7.9	200	82	21.2	600	1/4	3/8	10

[Vertical Sanders/Polishers]



TPT-480
7" Heavy Duty Angle
Sander



TPT-481
7" Heavy Duty Vertical
Sander



TPT-490
7" Heavy Duty Angle
Polisher



TPT-491
7" Heavy Duty Vertical
Polisher

[Belt Sanders]



TPT-469
60mm Belt Sander



TPT-475
10mm Belt Sander



TPT-448
Straight Line Sander



TPT-476
20mm Belt Sander



TPT-474
30mm Belt Sander

Model	Pad/ Disc Size	Free Speed	Spindle Thread	Net Weight		Overall Length		Noise Level	Average Air Cons. @ Load		Air Inlet NPTF	Hose Size	
	inch	rpm	inch	lb	kg	inch	mm	dBA	cfm	L/min	inch	inch	mm
TPT-480	7	4,500	5/8 - 11	4.3	2.0	13	330	81	19	524	1/4	3/8	10
TPT-481	7	4,500	5/8 - 11	5.3	2.4	7.5	190	88	16	453	1/4	3/8	10
TPT-490	7	2,500	5/8 - 11	4.3	2.0	13	330	81	19	524	1/4	3/8	10
TPT-491	7	2,000	5/8 - 11	5.3	2.4	7.5	190	88	16	453	1/4	3/8	10

Model	Belt Size	Free Speed	Net Weight		Overall Length		Noise Level	Average Air Cons. @ Load		Air Inlet NPTF	Hose Size	
	mm	rpm	lb	kg	inch	mm	dBA	cfm	L/min	inch	inch	mm
TPT-469	60 x 260	7,000	2.4	1.1	11.8	300	82	19	540	1/4	3/8	10
TPT-475	10 x 330	18,000	2.0	0.9	11.0	280	88	4	113	1/4	3/8	10
TPT-448	408 x 64	2,300	6.6	3.0	16.4	416	80	4	113	1/4	3/8	10
TPT-476	20 x 520	17,000	2.9	1.3	14.8	375	86	3	85	1/4	3/8	10
TPT-474	30 x 540	13,000	4.6	2.1	15.4	390	92	3	85	1/4	3/8	10



Air Drills and Screwdrivers

■ Air Drills ■ Air Screwdrivers

[Air Drills]



TPT-600R
3/8" Reversible Drill



TPT-610R
1/2" Reversible Drill



TPT-605
3/8" Non-Reversible Drill,
with key chuck

TPT-605-4
1/2" Non-Reversible Drill,
with key chuck



TPT-601R
3/8" Reversible Drill



TPT-602R
1/2" Reversible Drill

Model	 Chuck Size	 No Free Speed	 Rated Power		 Net Weight		 Overall Length		 Noise Level	 Average Air Cons. @ Load		 Air Inlet NPTF	 Hose Size	
	inch	rpm	hp	KW	lb	kg	inch	mm	dBA	cfm	L/min	inch	inch	mm
TPT-600R	3/8	1,800	0.5	0.4	2.9	1.3	7.0	177	87	8.5	240	1/4	3/8	10
TPT-610R	1/2	750	0.5	0.4	4.0	1.8	8.0	203	87	8.5	240	1/4	3/8	10
TPT-605	3/8	2,200	0.5	0.4	2.2	1.0	7.0	177	87	10.0	283	1/4	3/8	10
TPT-605-4	1/2	2,200	0.5	0.4	2.2	1.0	7.0	177	87	10.0	283	1/4	3/8	10
TPT-601R	3/8	2,300	0.5	0.4	2.9	1.3	7.5	191	83	10.0	283	1/4	3/8	10
TPT-602R	1/2	500	0.5	0.4	4.0	1.8	9.0	228	83	10.0	283	1/4	3/8	10

[Inline Air Drills]



TPT-606
1/2" Non-Reversible Drill



TPT-607
1/2" Non-Reversible Drill



TPT-608
3/8" Non-Reversible Drill



TPT-527
3/8" Air Straight Drill



TPT-527F
3/8" Air Drill with Composite Housing

Model	Chuck Size	No Free Speed	Rated Power		Net Weight		Overall Length		Noise Level	Average Air Cons. @ Load		Air Inlet NPTF		Hose Size
	inch	rpm	hp	KW	lb	kg	inch	mm	dBA	cfm	L/min	inch	inch	mm
TPT-606	1/2	800	0.5	0.4	4.0	1.8	8.0	203	87	8.5	241	1/4	3/8	10
TPT-607	1/2	500	0.5	0.4	4.0	1.8	9.0	228	87	8.5	241	1/4	3/8	10
TPT-608	3/8	1,500	0.5	0.4	2.4	1.1	7.8	197	75	3.0	85	1/4	3/8	10

Model	Chuck Size	No Free Speed	Rated Power		Net Weight		Overall Length		Noise Level	Average Air Cons. @ Load		Air Inlet NPTF		Hose Size
	inch	rpm	hp	KW	lb	kg	inch	mm	dBA	cfm	L/min	inch	inch	mm
TPT-527	3/8	2,000	0.5	0.4	2.4	1.1	7.9	201	75	3.0	85	1/4	3/8	10
TPT-527F	3/8	2,000	0.5	0.4	2.2	1.0	8.6	218	85	9.9	280	1/4	3/8	10

[Accessories for Air Drills]

600R-032 Handle rubber
Apply to: TPT-600R, TPT-610R



[Air Screwdrivers]

TPT-747
1/4" Screwdriver



TPT-769
1/4" Screwdriver

TPT-758H
1/4" Screwdriver



TPT-722
1/4" Angle Screwdriver



Model	Bolt Capacity	No Free Speed	Max Max Torque	Net Weight	Overall Length	Noise Level	Average Air Cons. @ Load	Air Inlet NPTF	Hose Size
	mm	rpm	in-lbs Nm	lb kg	inch mm	dBA	cfm L/min	inch	inch mm
TPT-747	M5	11,000	195 22	1.8 0.8	7.4 187	96	2.5 70	1/4	1/4 6.4
TPT-758H	M6-M8	9,000	531 60	2.2 1.0	8.5 215	90	4.0 113	1/4	1/4 6.4
TPT-769	M6-M8	8,500	531 60	2.6 1.2	6.5 165	86	4.0 113	1/4	1/4 6.4
TPT-722	M4-M5	9,000	354 40	2.6 1.2	9.4 240	87	4.5 127	1/4	1/4 6.4



TPT-761
1/4" Screwdriver



TPT-765
1/4" Torque Control Screwdriver



TPT-764
1/4" Torque Control Screwdriver

Model	Bolt Capacity	No Free Speed	Max Max Torque	Net Weight	Overall Length	Noise Level	Average Air Cons. @ Load	Air Inlet NPTF	Hose Size
	mm	rpm	in-lbs Nm	lb kg	inch mm	dBA	cfm L/min	inch	inch mm
TPT-761	M6-M8	8,000	443 50	2.6 1.2	6.5 165	87	5.8 165	1/4	1/4 6.4
TPT-764	M6-M8	1,800	115 13	2.4 1.1	7.0 178	87	4.0 113	1/4	1/4 6.4
TPT-765	M6-M8	800	142 16	2.6 1.2	8.5 216	97	4.0 113	1/4	1/4 6.4



Air Hammers and Needle Scalers

■ Air Hammers ■ Needle Scalers



TPT-684N
Air Hammer,
with round shank opening

TPT-684NH
with hex shank opening



TPT-685N
Air Hammer,
with round shank opening

TPT-685NH
with hex shank opening

Model	Shank Opening		Stroke Speed	Power	Stroke Length		Net Weight		Overall Length		Noise Level	Air cons. @Load		Air Inlet NPTF	Hose Size	
	inch	mm	b.p.m	Joule	inch	mm	lb	kg	inch	mm	dB(A)	cfm	L/min	inch	inch	mm
TPT-684N	0.401 Round	10.2	3,200	9	2.5	63	4.4	2.0	6.8	173	99	3.9	110	1/4	3/8	10
TPT-684NH	0.401 Hex	10.0	3,200	9	2.5	63	4.4	2.0	6.8	173	99	3.9	110	1/4	3/8	10
TPT-685N	0.401 Round	10.2	2,100	12	3.4	87	5.0	2.3	8.8	223	99	3.9	110	1/4	3/8	10
TPT-685NH	0.401 Hex	10.0	2,100	12	3.4	87	5.0	2.3	8.8	223	99	3.9	110	1/4	3/8	10
TPT-686	0.401 Round	10.2	3,000	8	2.2	56	3.3	1.7	7.9	206	103	6.2	176	1/4	3/8	10
TPT-686H	0.401 Hex	10.0	3,000	8	2.2	56	3.3	1.7	7.9	206	103	6.2	176	1/4	3/8	10



Air Hammer Kit:

TPT-684N(H)K, TPT-685N(H)K

Make your life easy

- Choose a ready to use startup kit for metal working or concrete and stone jobs
- Protect and store your tool and accessories together in a handy high quality case

Kit includes: • Air Hammer • Quick Change Retainer • 5-Piece Chisel • Blow Case



TPT-686

Air Hammer, includes
5-pcs chisel kit(190mm/Round)

TPT-686H

Includes
5-pcs chisel kit(190mm/Hex)



Quick Change Retainer

Part No.	Description
202A	QC Retainer For Shank Round/Hex

5-Piece Chisel Set

Model	Description
TST-9026	7" Chisel Set- Shank Hex (11mm/0.433")
TST-9027	7" Chisel Set- Shank Hex (10.2mm/0.401")
TST-9028	7" Chisel Set- Shank Round (10.2mm/0.401")

Chisel Shank 0.401"(10.2mm) Round & Hex / 0.433"(11mm) Hex

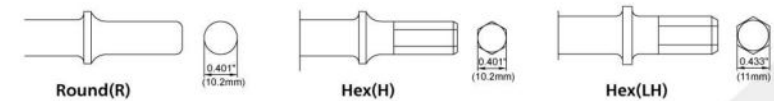

[Air Hammers]

TPT-930
Air Chipping Hammer
TPT-930H
with (0.58")14.7mm chisel, Hex



TPT-931
Air Chipping Hammer

TPT-931H
with (0.58")14.7mm chisel, Hex

TPT-932
Air Chipping Hammer

TPT-932H
with (0.58")14.7mm chisel, Hex



TPT-928
Air Scaling Hammer

TPT-929
Air Scaling Hammer

TPT-919
Air Riveting Hammer

[Needle Scalers]

TPT-922
Air Needle Scaler



TPT-921
Air Needle Scaler

Model	Needle Quantity	Stroke Speed	Needle Size		Net Weight		Overall Length		Noise Level	Average Air Cons. @ Load		Air Inlet NPTF		Hose Size	
	pcs	bpm	inch	mm	lb	kg	inch	mm	dBa	cfm	L/min	inch	inch	mm	
TPT-921	19	3,700	1/8	3	5.9	2.7	13.2	335	108	4.2	120	1/4	3/8	10	
TPT-922	35	2,500	1/8	3	13.2	6.0	18.1	460	112	7.1	200	1/4	3/8	10	
TPT-923(F)	19	4,400	1/8	3	6.2	2.8	16.1	410	104	6.7	190	1/4	3/8	10	
TPT-926	28	2,800	1/8	3	11.9	5.4	23.6	600	112	10.0	283	1/4	3/8	10	
TPT-920	19	3,700	1/8	3	5.9	2.7	14.8	375	108	4.2	120	1/4	3/8	10	



TPT-923
Air Needle Scaler

TPT-923F
Air Flux Chipper



TPT-926
Air Needle Scaler



TPT-920
Air Needle Scaler

Model	Shank Opening		Stroke Speed	Stroke Length		Net Weight		Overall Length		Noise Level	Average Air Cons. @ Load		Air Inlet NPTF		Hose Size	
	inch	mm	bpm	inch	mm	lb	kg	inch	mm	dBa	cfm	L/min	inch	inch	mm	
TPT-930	0.68	17.3	3,600	3.0	77	17.6	8.0	14.0	365	104	33.9	960	3/8	1/2	12.7	
TPT-930H	0.58 hex	14.7	3,600	3.0	77	17.6	8.0	14.0	365	104	33.9	960	3/8	1/2	12.7	
TPT-931	0.68	17.3	2,280	3.7	94	18.7	8.5	15.3	400	104	33.2	940	3/8	1/2	12.7	
TPT-931H	0.58 hex	14.7	2,280	3.7	94	18.7	8.5	15.3	400	104	33.2	940	3/8	1/2	12.7	
TPT-932	0.68	17.3	1,800	4.0	102	19.8	9.0	16.7	425	104	30.4	860	3/8	1/2	12.7	
TPT-932H	0.58 hex	14.7	1,800	4.0	102	19.8	9.0	16.7	425	104	30.4	860	3/8	1/2	12.7	
TPT-928	-	-	7,000	1.5	38	5.1	2.3	22.1	561	101	3.3	93	1/4	3/8	10	
TPT-929	-	-	2,400	1.0	26	8.8	4.0	21.3	541	104	7.8	221	3/8	3/8	10	
TPT-919	8mm	-	5,400	1.2	31	0.9	0.4	7.4	188	106	3.0	85	1/4	3/8	10	

[Needle Scalers]



TPT-924
Air Flux Chipper



TPT-925
Air Gasket Scraper



TPT-927-3L
23.6"(600mm) in length

TPT-927-4L
47.2"(1,200mm) in length

TPT-927-5L
59.1"(1,500mm) in length
Air Long Reach Scraper

Model	Stroke Speed	Stroke Length		Net Weight		Overall Length		Noise Level	Average Air Cons. @ Load		Air Inlet NPTF	Hose Size	
		bpm	inch	mm	lb	kg	inch		mm	cfm		L/min	inch
TPT-924	2,700	1.3	33	5.1	2.3	13.2	335	107	5.0	141	1/4	3/8	10
TPT-925	4,000	1.6	40	1.8	0.8	9.6	245	91	3.5	100	1/4	3/8	10
TPT-927-3L	2,400	1.5	38	10.6	4.8	23.6	600	109	10.0	283	1/4	3/8	10
TPT-927-4L	2,400	1.5	38	14.3	6.5	47.2	1,200	109	10.0	283	1/4	3/8	10
TPT-927-5L	2,400	1.5	38	16.1	7.3	59.1	1,500	109	10.0	283	1/4	3/8	10

Special Tools

Riveters and Nut Setters
Caulking Guns
Grease Guns
Concrete Breakers



[Nut Setters & Tappers]

Pulling Nut Size	Optional Pulling Nut				
	Steel	Aluminum	Steel	Aluminum	Steel
M3, M4	774H-32M4	774H-32M4	774H-32M4	774H-32M4	774H-32M4
M5, M6	774H-20M6	774H-20M6	774H-20M6	774H-20M6	774H-20M6
M6, M8	774H-08M8	774H-08M8	774H-08M8	774H-08M8	774H-08M8
M8, M10	774H-04M10	774H-04M10	774H-04M10	774H-04M10	774H-04M10



TPT-774H
Air Nut Setter

Model	Pulling Size	No Free Speed	Net Weight		Overall Length		Noise Level	Average Air Cons. @ Load		Air Inlet NPTF		Hose Size	
			lb	kg	inch	mm		cfm	L/min	inch	mm	inch	mm
TPT-774H-32M4	M3, M4	3,200	2.9	1.3	7.0	177	80	8.8	250	1/4	3/8	10	
TPT-774H-20M6	M5, M6	2,000	2.9	1.3	7.0	177	80	8.8	250	1/4	3/8	10	
TPT-774H-08M8	M6, M8	800	3.2	1.5	7.7	195	80	8.8	250	1/4	3/8	10	
TPT-774H-04M10	M8, M10	400	3.2	1.5	7.7	195	80	8.8	250	1/4	3/8	10	



TPT-775C / TPT-776C
Air Tapper
with 3/8" Key Chuck



TPT-775B / TPT-776B
Air Tapper
Tapped holder offered for option

Model	Tapping Capacity				No Free Speed	Shaft Type	Net Weight		Overall Length		Noise Level	Average Air Cons. @ Load		Air Inlet NPTF		Hose Size	
	Steel		Aluminum				lb	kg	inch	mm		cfm	L/min	inch	inch	mm	
	mm	inch	mm	inch													rpm
TPT-775C-330	M12	1/2	M14	9/16	330	JT#1	3.5	1.6	8.35	212	82	4.3	121	1/4	3/8	10	
TPT-775C-700	M8	5/16	M10	3/8	700		3.5	1.6	8.35	212	82	4.3	121	1/4	3/8	10	
TPT-776C-330	M12	1/2	M14	9/16	330	B-12	3.4	1.6	10.4	266	84	4.3	121	1/4	3/8	10	
TPT-775B-330	M12	1/2	M14	9/16	330		3.4	1.6	8.5	215	82	4.3	121	1/4	3/8	10	
TPT-775B-700	M12	1/2	M14	9/16	700	3.4	1.6	8.5	215	84.5	4.3	121	1/4	3/8	10		
TPT-776B-330	M12	1/2	M14	9/16	330	3.3	1.5	10.6	270	84	4.3	121	1/4	3/8	10		
TPT-776B-700	M12	1/2	M14	9/16	700	3.3	1.5	10.6	270	84	4.3	121	1/4	3/8	10		

*Side handle included with the pistol type tools. *The tools are not delivered with the tap holder.

[Caulking Guns]



TPT-645
Air Sprayer, Sealer & Caulking Gun



TPT-646
Air Adjustable Caulking Gun



TPT-670K
Air Wonder Gun Kit

Model	Cartridge / Sachet	Net Weight		Overall Length		Noise Level	Average Air Cons. @ Load		Air Inlet NPTF		Hose Size	
	Capacity	lb	kg	inch	mm		cfm	L/min	inch	inch	mm	
TPT-645	500ML / 310-600ML	2.6	1.2	15.2	386	70	2.0	57	1/4	1/4	6.4	
TPT-646	310ML	2.4	1.1	12.0	305	70	4.0	113	1/4	3/8	10	
TPT-670K	-	0.9	0.4	-	-	-	14.8	420	1/4	1/4	6.4	

[Riveters]



TPT-695
Air Hydraulic Riveter



TPT-696
Air Hydraulic Riveter

Model	Piston Stroke	Traction Power	Capacity		Net Weight		Overall Length		Noise Level	Average Air Cons. @ Load		Air Inlet NPTF		Hose Size	
			mm	inch	lb	kg	inch	mm		cfm	L/min	inch	inch	mm	
TPT-695	16	974	3/32-3/16	2.4-4.8	3.3	1.5	10.7	273	71	0.04	1	1/4	3/8	10	
TPT-696	16	1502	5/32-1/4	4-6.4	4.0	1.8	11.7	298	77	0.06	2	1/4	3/8	10	

[Grease Guns]



TKC-401
Air Continuous Grease Gun



TKC-500
Air Single Shot Grease Gun



TKC-505
Air Continuous Grease Gun

Model	Output Pressure	Capacity		Net Weight		Air Pressure		Air Inlet NPTF		Hose Size	
	PSI	cc	oz	lb	kg	PSI	kg/cm ²	inch	inch	mm	
TKC-401	1,600-4,000	400	14.0	3.7	1.7	40-100	2.8-7	1/4	3/8	10	
TKC-500	1,600-6,000	500	16.0	3.5	1.6	40-150	2.8-10.5	1/4	3/8	10	
TKC-505	1,600-6,000	500	16.0	3.5	1.6	40-150	2.8-10.5	1/4	3/8	10	

[Concrete Breakers]

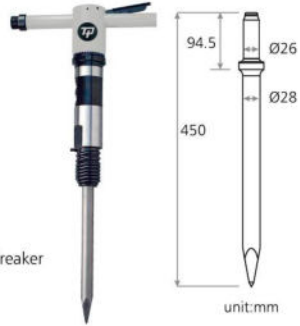

TPT-10S
Air Concrete Breaker

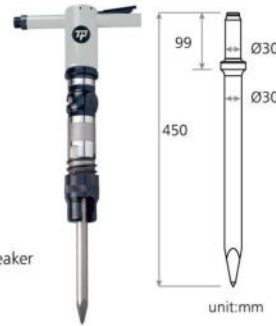

TPT-30S
Air Concrete Breaker

Model	Shank Opening	Stroke Speed	Stroke Length		Net Weight		Overall Length		Noise Level	Average Air Cons. @ Load		Air Inlet NPTF	Hose Size	
	mm	bpm	inch	mm	lb	kg	inch	mm	dBA	cfm	L/min	inch	inch	mm
TPT-10S	Round ø26	1,300	5.9	151	31	14.1	29.6	753	104	35.02	991	1/2	1/2	13
TPT-30S	Round ø30	1,000	9.3	235	54.2	24.6	34.6	880	104	42.01	1,189	1/2	3/4	19

[Accessories For TPT-10S/30S]



TPT-10S/30S-A
Unique Nut



TPT-10S18-B
1/2" & 3/4"
Hose Nipple



TPT-10S013-B
Retainer Spring
for TPT-10S



TPT-30S012-B
Hitch Cutter Retainer
for TPT-30S



TPT-609
Spot Weld Drill Kit with Counter Arm



TPT-617
Punching and Welding Tool



TPT-643
Air Glass Removable Tool

Model	Free Speed	Bit Size		Net Weight		Overall Length		Noise Level	Average Air Cons. @ Load		Air Inlet NPTF	Hose Size	
	rpm	mm	mm	lb	kg	inch	mm	dBA	cfm	L/min	inch	inch	mm
TPT-609	1,600	Ø8	Ø6.5	4.4	2.0	9.3	235	86	6.0	170	1/4	3/8	10

Model	Capacity	Punch Size	Flange Width	Net Weight		Overall Length		Noise Level	Average Air Cons. @ Load		Air Inlet NPTF	Hose Size	
	mm	mm	mm	lb	kg	inch	mm	dBA	cfm	L/min	inch	inch	mm
TPT-617	1.2(steel)/1.6(A)	Ø5	Ø12	2.9	1.3	9.8	248	70	0.03	0.8	1/4	3/8	10

Model	Free Speed	Net Weight	Overall Length		Noise Level	Average Air Cons. @ Load		Air Inlet NPTF	Hose Size		
	rpm	lb	kg	inch	mm	dBA	cfm	L/min	inch	mm	
TPT-643	20,000	2.2	1.0	7.9	200	80	3.0	85	1/4	3/8	10



[Digital Torque Wrenches]



GRAVITY

It is more precise to make the calibration in the Calibration Lab, after measuring the gravity by Taiwan National Science Council.

ISO 17025

Every torque wrench in DTW series is tested in the Calibration Lab. Complies with the ISO: 17025.



THE CALIBRATION MACHINE

Every torque wrench has been approved by the Calibration Lab. And the test report is Internationally valid, which is granted by laboratories in numerous countries.



Calibration Laboratory

Calibration Laboratory

The Calibration Lab. is one of the members of Taiwan Accreditation Foundation (TAF).



Every torque wrench in DTW series complies with ISO:6789 and must pass 100% strict quality inspection and test.

Model	SQ Drive	Nm	Ft-lbs	In-lbs	Kgm	Length (mm)	Weight (kg)
DTW-3135	3/8"	10-135	7.4-99.6	89-1,198	1-13.7	400	1.2
DTW-4135	1/2"	10-135	7.4-99.6	89-1,198	1-13.7	400	1.2
DTW-3200	3/8"	20-200	14.8-147	178-1,780	2-20.4	570	1.6
DTW-4200	1/2"	20-200	14.8-147	178-1,780	2-20.4	570	1.6
DTW-4340	1/2"	34-340	25-250.9	303-3,010	3.5-34.7	770	2

Accuracy	CW±2%+1 LSD/CCW±3%+1 LSD
Direction	Clockwise/Counter-clockwise
Torque Unit	Nm/Ft-lbs/In-lbs/Kgm
Battery	9V(Alkaline)x1
Operation Temperature	5~42°C, 40~107°F
Storage Temperature	-20~50°C, -4~107°F
Power	Auto shutdown after 90 seconds idle

Accessories

[Maintenance Parts]



TPA-B20
Tire Pressure Gauge

TPA-B25
Tire Pressure Gauge

Model	Port Size	Filter Element	Adjustment Pressure	Max Service Pressure	Max Flow	Drain Capacity	Oil Capacity
	inch	μ	kg/cm ²	kg/cm ²	L/min	ml	ml
TPA-804FRL	1/4, 3/8, 1/2	20	0.5 - 9.9	15	1,750-2,200	80	125
TPA-202FRL	1/4	20	0.5 - 9.9	10	1,100	15	30

Model	Port Size	Nozzle Length	Max Pressure	
	inch	cm	PSI	kg/cm ²
TPA-B20	1/4	30	200	14
TPA-B25	1/4	85	200	14